

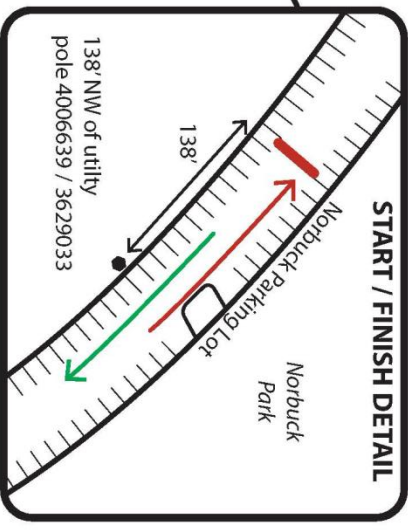

10K MAP

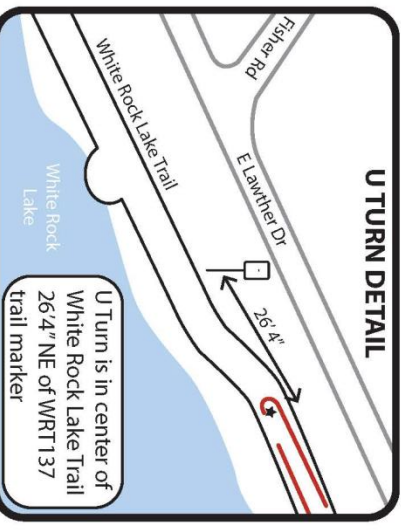
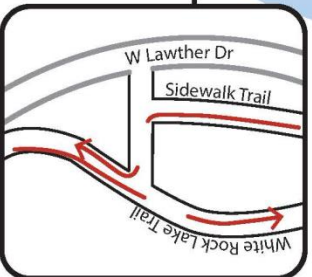
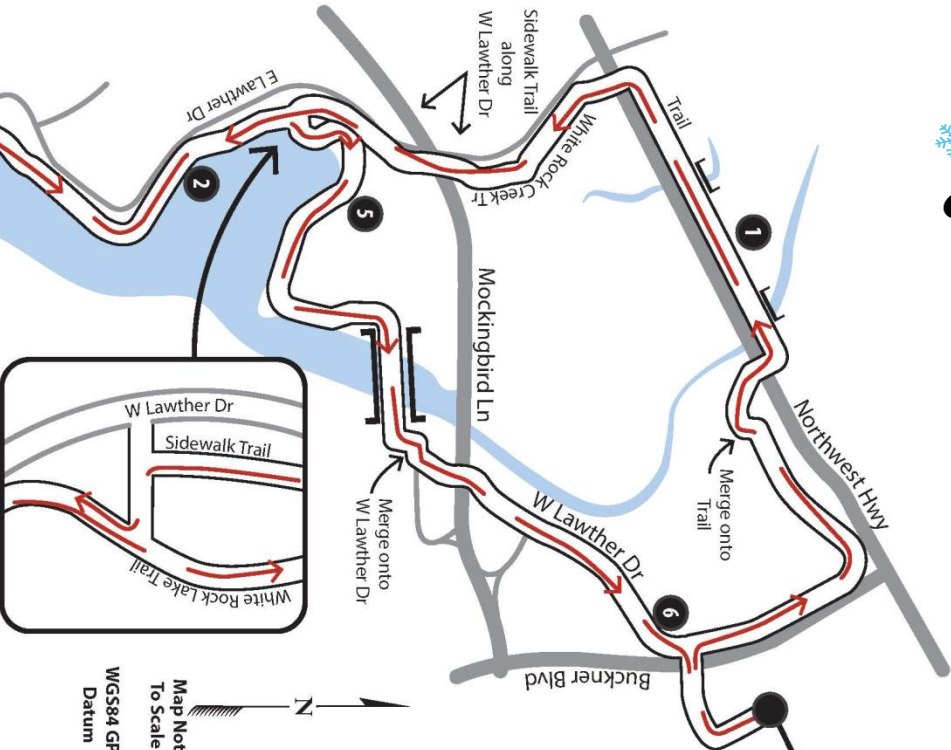

- Start / Finish** – (N32.51 30.5 W96.42 59.4) – Norbuck Parking Lot – 138' N of utility pole 4006639 / 3629033
- Mile 1** – (N32.51 26.7 W96.43 39.9) – 258' E of western bridge over White Rock Creek
- Mile 2** – (N32.50 48.1 W96.43 40.5) – WRLT near 4600 W Lawther Parking Lot – 45' S of northern stone entry
- Mile 3** – (N32.50 14.6 W96.43 25.1) – WRLT – 108' S of WRT139 trail marker
- Mile 5 km** – (N32.50 09.5 W96.43 28.2) – WRLT – 27.4' N of WRT138 trail marker
- U Turn** – (N32.50 03.7 W96.43 37.4) – WRLT – 26.4' NE of WRT137 trail marker – near 4001 W Lawther
- Mile 4** – (N32.50 21.2 W96.43 44.2) – WRLT – 152' N of WRT142 trail marker
- Mile 5** – (N32.51 02.4 W96.43 43.7) – WRLT – 98' NW of WRT151 trail marker
- Mile 6** – (N32.51 24.9 W96.43 04.7) – E Lawther Dr – 81' S of STOP sign at underpass

Logan Burgess

Measured by Logan Burgess
USATF / RRTC Course Certifier
AIMS / IAAF Level B Measure



Run Local. Give Local.